

SPECIFICATION	CONNECTION	VALUE
GEAR RATIO		20
EFFICIENCY		90.00%
BACKLASH@NO-LOAD(arcmin)		<=50
MAX.PERMISSIBLE TORQUE(Nm)[lb-in]		25.00[221.27]
SHAFT MAXIMUM AXIAL LOAD(N)		200
SHAFT MAXIMUM RADIAL LOAD(N)		400
GEARBOX MATCHING MOTOR'S INPUT SHAFT LENGTH (mm)		13.5±0.5
NOISE(dB)		<=60
WATERPROOF RATING		IP54
AMBIENT TEMPERATURE		-10°C~90°C[14°F~194°F]

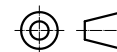

	APVD		10.21.2021
	CHKD		
2:3	DRN		
SCALE	SIGNATURE		DATE

PLANETARY GEARBOX

TQMG23-G20-D8